

TOTAL MILES
 Township Road System 88.29*
 State Highway System 34.14
 Total 122.43

* Includes ACT 32 Turnback Mileage of 0.16

POPULATION 20,458
 (2020 Census)

LEGEND

- LIMITED ACCESS HIGHWAY
- STATE ROUTE AND NUMBER
- STATE MAINTAINED BRIDGE ON TOWNSHIP ROAD
- TOWNSHIP ROAD, NUMBER AND SEGMENT LENGTH IN MILES
- IMPASSABLE TOWNSHIP ROAD
- TURNBACK TOWNSHIP ROAD
- OTHER ROAD
- RAILROAD (IN SERVICE)
- RAILROAD ABANDONED (TRACK RETAINED)
- STATE BOUNDARY
- COUNTY BOUNDARY
- TOWNSHIP BOUNDARY
- CITY OR BOROUGH BOUNDARY
- MUNICIPAL BUILDING
- SPLIT MILEAGE BETWEEN MUNICIPALITIES

- 200 LONGVIEW RD
- 201 LOZAR RD
- 202 KEEN RD
- 203 BROWNBACK RD
- 204 POSSUM HOLLOW RD
- 205 LIGHTCAP RD
- 206 AIRPORT RD
- 207 RUFFERT RD
- 208 PRANK RD
- 209 FRUITVILLE RD
- 210 PRUSS HILL RD
- 211 SMITH RD
- 212 KURTZ RD
- 213 HOUER RD
- 214 MILL RD
- 215 GREER RD
- 216 STEINWETZ RD
- 217 SWAMPCREEK RD
- 218 LAKER RD
- 219 GERLOFF RD
- 220 BRACK RD
- 221 BETTY LA
- 222 KOBERT LA
- 223 SHAWY LA
- 224 SANKEY RD
- 225 SHERIDAN RD
- 300 CHURCH RD
- 301 REFINED RD
- 302 BORATEN RD
- 303 SACD RD
- 304 PENNACRET RD
- 305 RAILROAD ST
- 307 TRINLEY DR
- 308 WILL LA
- 309 WADJO RD
- 310 MAJOR HOLLOW RD
- 311 FERRALE LA
- 312 BREWER RD
- 313 REED RD
- 315 OAK LA
- 316 CHERRY LA
- 318 LUMPHICK RD
- 319 SPRINGWOOD RD
- 320 KUGLER RD
- 321 ZETGLER RD
- 322 METKA RD
- 323 HIGHLAND RD
- 324 RYANFORD RD
- 325 GRATERFORD RD
- 326 HOCKLE RD
- 327 WINE RUN RD
- 328 WENG RD
- 400 WALTERS LA
- 401 WAREL DR
- 402 KING RD
- 403 COUNTRY CLUB RD
- 404 SUNSET RD
- 405 CHAPEL RD
- 406 OAK ST
- 407 SPRING ST
- 408 NINTH ST
- 409 WOKERSFORD RD
- 410 BUCKWALTER RD
- 411 OLD MILL RD
- 412 SOUBER RD
- 413 SPRING LAKE RD
- 414 HEFFNER RD
- 415 SCHOL RD
- 416 Saylor RD
- 417 CEMETERY RD
- 418 DEERFIELD RD
- 419 MEWER LA
- 420 REIFFENTOR RD
- 421 COTTAGE RD
- 422 COLLINS LA
- 423 DONLAFY CIR
- 424 HAINES DR
- 425 KOCH DR
- 426 KIRKHOUSE DR
- 427 DETLEDER DR
- 428 CALTE WY
- 429 SHANNON WY
- 430 SEVERIN AV
- 431 PRUMER DR
- 432 MELISSA LA
- 433 INDUSTRIAL HWY
- 434 DEISINGER DR
- 435 MARIA LA
- 436 MOSES LA
- 437 BLOSSOM LA
- 438 LANDIS CREEK LA
- 439 JOAC CIR
- 440 SARA LA
- 441 HENRY DR
- 442 MILLER CIR
- 443 WILLIAM PENN CIR
- 444 ELIO CIR
- 445 WINDFIELD DR
- 446 SPRING HAVEN CIR
- 447 LAVISTOCK DR
- 448 LAURES DR
- 449 AZALEA CIR
- 450 HICKORY GROVE DR
- 451 BAYBERRY DR
- 452 WISTERIA DR
- 453 SYCAMORE DR
- 454 MULBERRY DR
- 455 SPRINGWOOD DR
- 456 BUTTWOOD DR
- 457 HEMLOCK WY
- 458 CHAMPANTE DR
- 459 QUEEN LA
- 460 VICTORY WY
- 461 LION CT
- 462 PAGANT CT
- 463 ARONIMINK DR
- 464 NAVAGUE DR
- 465 CHEROKEE CT
- 466 APACHE LA
- 467 LAURA LA
- 468 LORRAINE RD
- 469 FOX DR
- 470 ABBER CT
- 471 SHAMROCK CT
- 472 KILNICK WY
- 473 KILNARRY WY
- 474 KEYFORD CT
- 475 DONOGAL CT
- 476 HEATHER DR
- 477 THORNBERY WY
- 478 TURRET DR
- 479 LARCHWOOD DR
- 480 MERION DR
- 481 SAUCON CT
- 482 WOODCREST CIR
- 483 FUNK DR
- 484 COLIN CT
- 485 MOODY RD
- 486 WALSHY RD
- 487 DUBLIN CT
- 488 FIELOSTONE DR
- 489 CRISTWILL LA
- 490 CRISTWILL LA
- 491 KING WAY
- 492 WEDAL DR
- 493 CASTLE DR
- 494 ANDERSON DR
- 495 ROSE CT
- 496 PERRY CT
- 497 PARNELL LA
- 498 LINDSEY LA
- 499 EDWARDS DR
- 500 HARTNETT LA
- 501 KNIGHT DR
- 502 LONG MEADOW RD
- 503 CONVERSE CIR
- 504 BUCKLEY CIR
- 505 CREEK VIEW CIR
- 506 AUTUMN LA
- 507 ARBOR CT
- 508 ELLIOT CT
- 509 CONNOR DR
- 510 NORMAN CT
- 511 BARLETT DR
- 512 TANGLEWOOD DR
- 513 BRADSHAW DR
- 514 ASHLEY DR
- 515 SEVENOAKS CIR
- 516 GRANDVIEW DR
- 517 KENDALL LA
- 518 LEE DR
- 519 ROSEBROOK TRAIL
- 520 SUNNYSIDE LA
- 521 MENSEL CIR
- 522 JESSICA CIR
- 523 DUNHAM SPRING
- 524 ASHFORD WY
- 525 LINDSEY CIR
- 526 SUN VALLEY DR
- 527 BRANK RD
- 528 SUNNY BROOK RD
- 529 BROADLEAF CIR
- 530 WILLOW WOOD DR
- 531 ASHBROOK DR
- 532 ST ANDREW'S LLOYD
- 533 SANDTRAP DR
- 534 DUSSELDORF DR
- 535 GLENDALES RD
- 536 LONGCROSS DR
- 537 TERRY AV
- 538 EVANSBROOK LA
- 539 FINLEY CIR
- 540 PINE TREE DR
- 541 FOREST GLEN DR
- 542 SORFA CT
- 543 NICHOLAS CT
- 544 BELLA ROSA CT
- 545 WALNUT ST
- 546 ZORNO CT
- 547 BOSTON CIR
- 548 COLORADO CT
- 549 ZARA DR
- 550 JONATHAN WY
- 551 ANNETTE DR
- 552 EILEEN LA
- 553 INVERNESS CIR
- 554 PRESIDENT CT
- 555 BAYHILL CIR
- 556 BRENNER LA
- 557 TURNBERRY DR
- 558 MENTHORN CIR
- 559 OAK CREEK DR
- 560 GREEN MEADOW CT
- 561 HUNTERSBOURD CT
- 562 WASTERS DR
- 563 TER CT
- 564 PAR CIR
- 565 BUNKER WAY
- 566 PUTTER LA
- 567 WEDGE CT
- 568 MONTILLA CIR
- 569 TRISTEN WY
- 570 PHAETON WY
- 571 MOUNTAIN VIEW LN
- 572 PENNSTONE CT
- 573 WOODMONT CT
- 574 PALMER PL
- 575 WINDO WAY
- 576 JAMESON DR
- 577 ELLSWORTH WAY
- 578 NORTHWOOD LA
- 579 NORFELD DR
- 580 GREENWOOD CT
- 581 STONBROOK CT

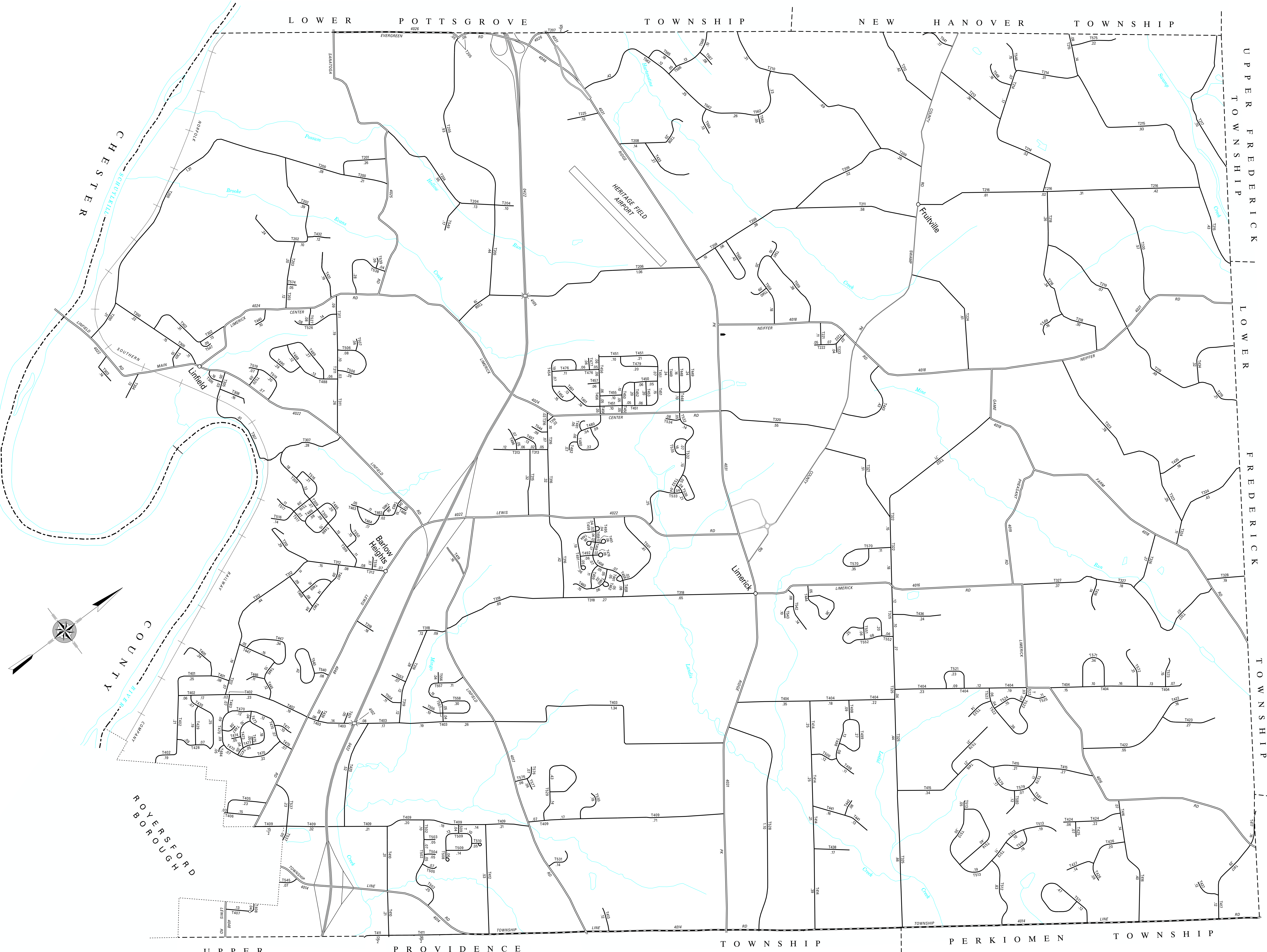

LIMERICK
 SECOND CLASS TOWNSHIP MAP
 MONTGOMERY COUNTY

PREPARED BY THE
 PENNSYLVANIA DEPARTMENT OF TRANSPORTATION
 BUREAU OF PLANNING AND RESEARCH
 GEOGRAPHIC INFORMATION DIVISION
 IN COOPERATION WITH THE
 U.S. DEPARTMENT OF TRANSPORTATION
 FEDERAL HIGHWAY ADMINISTRATION
 MUNICIPAL CODE 46 205
 THIS MAP IS PUBLISHED AS A SUPPLEMENTAL
 DOCUMENTATION OF LIQUID FUELS TAX FUND MILEAGES
 REVISED PER FORM 990 DATED 1-13-26

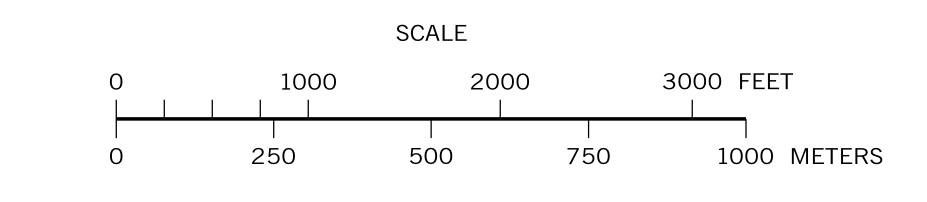

COPIES OF THIS MAP ARE AVAILABLE AT NOMINAL COST
 CONTACT:
 PENNSYLVANIA DEPARTMENT OF TRANSPORTATION
 SALES STORE
 HARRISBURG, PENNSYLVANIA 17105-3483
 TELEPHONE: (717)787-6246

CREATED BY LIP 2-24-98 (REVISED 1-22-26)

TYPE 5 MAP LIMERICK TOWNSHIP MONTGOMERY COUNTY PENNSYLVANIA